



CREATIVE URBAN LIGHTING FURNITURE

LIGHTPOST

MODEL P (Patent pending)

NEW ALUMINUM TAPERED POLE ASSEMBLY
CHEMICALLY BOUNDED TOGETHER

DIGITALLY INKJET PRINTED SURFACES WITH
HIGH-DEFINITION IMAGES OF VARIOUS TEXTURES

TOTALLY PREWIRED LOW VOLTAGE (24 VDC)

INTEGRATED LED ACCENTS

UV CLEAR COAT " DUROCLEAR " TO PROTECT
AGAINST FADING



BRINGING TO LIFE A NEW
AESTHETIC DIMENSION WITH
UNIQUE LIGHT SIGNATURE

www.zilux.com

TECHNICAL SHEET

LIGHTPOST MODEL P (Patent pending)

LUMINAIRE

LUMINAIRE HEAD INTEGRATING 2 UNIVERSAL SEALED LED MODULES ADJUSTED TO 18 WATTS EACH (0-20 WATTS MAX). OFFERED IN TYPE II, III OR V LIGHT DISTRIBUTION.

(UP TO 140 LUMENS PER WATT)

*3 LED MODULES AVAILABLE IN OPTION.

LED ACCENT

STANDARD WHITE STRIPS LED INTEGRATED ON TWO SIDES OF THE LUMINAIRE AND CORNERS OF THE POLE ARE HIDDEN BY AN ACRYLIC STRIPE PRINTED WITH THE SAME TEXTURE AS POLE.(0-100 LUMENS/ WATT).

CHOICE OF LED COLORS AVAILABLE IN OPTION:

(RGBW for luminaire head only)

R P G B GB Y RGBW



24 VOLTS SYSTEM

LIGHTPOST PREWIRED 24 VOLTS AND INTEGRATES A UNIVERSAL TWIST - LOCK TENON FOR QUICK AND SAFE WIRELESS CONNECTION.



24
VOLTS

ALUMINUM TAPERED POLE

NEW ARCHITECTURAL TAPERED POLE ASSEMBLY, CHEMICALLY BOUNDED TOGETHER. TESTED TO WITHSTAND GREATER LOADS AND WINDS ALMOST TWICE THAT OF REGULAR ALUMINUM POLE.

(REFER TO OUR WEBSITE FOR TESTS)

DIGITAL PRINTING

DIGITALLY INKJET PRINTED SURFACES WITH HIGH-DEFINITION IMAGES OF VARIOUS TEXTURES.

IMAGE
OF SELECTED
TEXTURE

"DUROCLEAR" COATING

APPLICATION OF A PROTECTIVE UV CLEAR COAT "DUROCLEAR" TO INCREASE LONG-TERM DURABILITY, PROTECT AGAINST FADING AND EXTEND LIFE WEATHERING.

DRIVER

2 DRIVERS 96W CLASSE 2 IP67 (120-277V-50/60HZ). MOUNTED ON A PLATE AT THE BASE OF THE POLE BEHIND THE ACCESS DOOR, EASILY DISCONNECTABLE. EACH DRIVER COMES WITH A POTENTIOMETER THAT ALLOWS INDIVIDUAL DIMMING OF ACCENTS AND FUNCTIONAL LIGHTING. THE DRIVER INCLUDES 5 OPTIONS DIMMING (RX, TRIAC, 0-10 V, 1-10 V, 10 V PWM).

OPERATING TEMPERATURE: -40 °C TO 70 °C.

BASE PLATE AND COVER

DUAL BOLT CIRCLES (IMAGE).
DIGITALLY PRINTED BASE COVER.

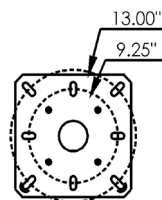

6.5"

12.5"

OPTIONS

- TEXTURE/COLOR
- LED ACCENT ON POLE AND LUMINAIRE
- HEIGHT

*Refer to Specification Sheet

lux
AESTHETICALLY LUMINOUS

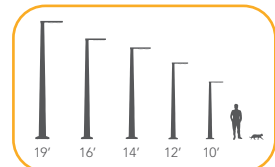

version 02 | 2024-06-03

We reserve the right to change specifications and equipment without notice.



CREATIVE URBAN LIGHTING FURNITURE

LIGHTPOST

MODEL V (Patent pending)

NEW ALUMINUM TAPERED POLE ASSEMBLY
CHEMICALLY BOUNDED TOGETHER

DIGITALLY INKJET PRINTED SURFACES WITH
HIGH-DEFINITION IMAGES OF VARIOUS TEXTURES

TOTALLY PREWIRED LOW VOLTAGE (24 VDC)

INTEGRATED LED ACCENTS

UV CLEAR COAT " DUROCLEAR " TO PROTECT
AGAINST FADING



z luxTM
AESTHETICALLY LUMINOUS

BRINGING TO LIFE A NEW
AESTHETIC DIMENSION WITH
UNIQUE LIGHT SIGNATURE

www.zilux.com

TECHNICAL SHEET

LIGHTPOST MODEL V (Patent pending)

LUMINAIRE

SQUARE SHAPE LUMINAIRE HEAD WITH SIDE LENSES INTEGRATING 4 UNIVERSAL SEALED LED MODULES ADJUSTED TO 18 WATTS EACH (0-20 WATTS MAX). OFFERED IN TYPE II, III OR V LIGHT DISTRIBUTION. (UP TO 140 LUMENS PER WATT)

LED ACCENT

STANDARD WHITE STRIPS LED INTEGRATED ON 4 SIDES OF THE LUMINAIRE AND CORNERS OF THE POLE ARE HIDDEN BY AN ACRYLIC STRIPE PRINTED WITH THE SAME TEXTURE AS POLE.

CHOICE OF LED COLORS AVAILABLE IN OPTION:



24 VOLTS SYSTEM

THE LIGHTPOST IS PREWIRED 24 VOLTS AND INTEGRATES A UNIVERSAL TWIST - LOCK TENON FOR QUICK AND SAFE WIRELESS CONNECTION.



ALUMINUM TAPERED POLE

NEW ARCHITECTURAL TAPERED POLE ASSEMBLY, CHEMICALLY BOUNDED TOGETHER. TESTED TO WITHSTAND GREATER LOADS AND WINDS ALMOST TWICE THAT OF REGULAR ALUMINUM POLE. (REFER TO OUR WEBSITE FOR TESTS)

DIGITAL PRINTING

DIGITALLY INKJET PRINTED SURFACES WITH HIGH-DEFINITION IMAGES OF VARIOUS TEXTURES.



"DUROCLEAR" COATING

APPLICATION OF A PROTECTIVE UV CLEAR COAT "DUROCLEAR" TO INCREASE LONG-TERM DURABILITY, PROTECT AGAINST FADING AND EXTEND LIFE WEATHERING.

DRIVER

2 DRIVERS 96W CLASSE 2 IP67 (120-277V-50/60HZ). MOUNTED ON A PLATE AT THE BASE OF THE POLE BEHIND THE ACCESS DOOR, EASILY DISCONNECTABLE. EACH DRIVER COMES WITH A POTENTIOMETER THAT ALLOWS INDIVIDUAL DIMMING OF ACCENTS AND FUNCTIONAL LIGHTING. THE DRIVER INCLUDES 5 OPTIONS DIMMING (RX, TRIAC, 0-10 V, 1-10 V, 10 V PWM).

OPERATING TEMPERATURE: -40 °C TO 70 °C.

BASE PLATE AND COVER

DUAL BOLT CIRCLES (IMAGE). DIGITALLY PRINTED BASE COVER.

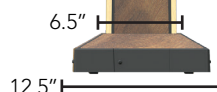
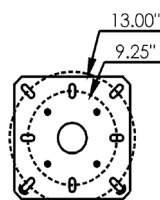

luxTM
AESTHETICALLY LUMINOUS

OPTIONS

- TEXTURE/COLOR
- LED ACCENT ON POLE AND LUMINAIRE
- HEIGHT

*Refer to Specification Sheet

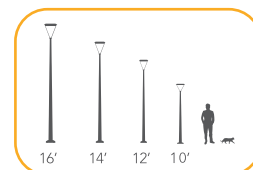

version 02 | 2024-06-03

We reserve the right to change specifications and equipment without notice.



CREATIVE URBAN LIGHTING FURNITURE

LIGHTPOST

MODEL F (Patent pending)

NEW ALUMINUM TAPERED POLE ASSEMBLY
CHEMICALLY BOUNDED TOGETHER

DIGITALLY INKJET PRINTED SURFACES WITH
HIGH-DEFINITION IMAGES OF VARIOUS TEXTURES

TOTALLY PREWIRED LOW VOLTAGE (24 VDC)

INTEGRATED LED ACCENTS

UV CLEAR COAT " DUROCLEAR " TO PROTECT
AGAINST FADING



z lux™
AESTHETICALLY LUMINOUS

BRINGING TO LIFE A NEW
AESTHETIC DIMENSION WITH
UNIQUE LIGHT SIGNATURE

www.zilux.com

TECHNICAL SHEET

LIGHTPOST MODEL F (Patent pending)

LUMINAIRE

SQUARE SHAPE LUMINAIRE HEAD WITHOUT SIDE LENSES INTEGRATING 4 UNIVERSAL SEALED LED MODULES ADJUSTED TO 18 WATTS EACH (0-20 WATTS MAX). OFFERED IN TYPE II, III OR V LIGHT DISTRIBUTION.
(UP TO 140 LUMENS PER WATT)

LED ACCENT

STANDARD WHITE STRIPS LED INTEGRATED ON 4 SIDES OF THE LUMINAIRE AND CORNERS OF THE POLE ARE HIDDEN BY AN ACRYLIC STRIPE PRINTED WITH THE SAME TEXTURE AS POLE.

CHOICE OF LED COLORS AVAILABLE IN OPTION:



24 VOLTS SYSTEM

THE LIGHTPOST IS PREWIRED 24 VOLTS AND INTEGRATES A UNIVERSAL TWIST-LOCK TENON FOR QUICK AND SAFE WIRELESS CONNECTION.



ALUMINUM TAPERED POLE

NEW ARCHITECTURAL TAPERED POLE ASSEMBLY, CHEMICALLY BOUNDED TOGETHER. TESTED TO WITHSTAND GREATER LOADS AND WINDS ALMOST TWICE THAT OF REGULAR ALUMINUM POLE.
(REFER TO OUR WEBSITE FOR TESTS)

DIGITAL PRINTING

DIGITALLY INKJET PRINTED SURFACES WITH HIGH-DEFINITION IMAGES OF VARIOUS TEXTURES.



"DUROCLEAR" COATING

APPLICATION OF A PROTECTIVE UV CLEAR COAT "DUROCLEAR" TO INCREASE LONG-TERM DURABILITY, PROTECT AGAINST FADING AND EXTEND LIFE WEATHERING.

DRIVER

2 DRIVERS 96W CLASSE 2 IP67 (120-277V-50/60HZ). MOUNTED ON A PLATE AT THE BASE OF THE POLE BEHIND THE ACCESS DOOR, EASILY DISCONNECTABLE. EACH DRIVER COMES WITH A POTENTIOMETER THAT ALLOWS INDIVIDUAL DIMMING OF ACCENTS AND FUNCTIONAL LIGHTING. THE DRIVER INCLUDES 5 OPTIONS DIMMING (RX, TRIAC, 0-10 V, 1-10 V, 10 V PWM).

OPERATING TEMPERATURE: -40 °C TO 70 °C.

BASE PLATE AND COVER

DUAL BOLT CIRCLES (IMAGE).
DIGITALLY PRINTED BASE COVER.

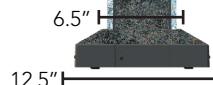
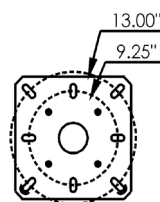

lux
AESTHETICALLY LUMINOUS

OPTIONS

- TEXTURE/COLOR
- LED ACCENT ON POLE AND LUMINAIRE
- HEIGHT

*Refer to Specification Sheet

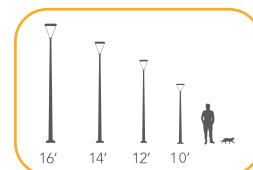

version 02 | 2024-06-03

We reserve the right to change specifications and equipment without notice.



CREATIVE URBAN LIGHTING FURNITURE

LIGHTPOST

MODEL R (Patent pending)

NEW ALUMINUM TAPERED POLE ASSEMBLY
CHEMICALLY BOUNDED TOGETHER

DIGITALLY INKJET PRINTED SURFACES WITH
HIGH-DEFINITION IMAGES OF VARIOUS TEXTURES

TOTALLY PREWIRED LOW VOLTAGE (24 VDC)

INTEGRATED LED ACCENTS

UV CLEAR COAT "DUROCLEAR" TO PROTECT
AGAINST FADING



z luxTM
AESTHETICALLY LUMINOUS

BRINGING TO LIFE A NEW
AESTHETIC DIMENSION WITH
UNIQUE LIGHT SIGNATURE

www.zilux.com

TECHNICAL SHEET

LIGHTPOST MODEL R (Patent pending)

LUMINAIRE

ROUND SHAPE LUMINAIRE HEAD WITH LENS
INTEGRATING 4 UNIVERSAL SEALED LED MODULES
ADJUSTED TO 18 WATTS EACH (0-20 WATTS MAX).
OFFERED IN TYPE II, III OR V LIGHT DISTRIBUTION.
(UP TO 140 LUMENS PER WATT)

LED ACCENT

STANDARD WHITE STRIPS LED INTEGRATED ON 4 SIDES
OF THE LUMINAIRE AND CORNERS OF THE POLE ARE
HIDDEN BY AN ACRYLIC STRIPE PRINTED WITH THE
SAME TEXTURE AS POLE.

CHOICE OF LED COLORS AVAILABLE IN OPTION:



24 VOLTS SYSTEM

THE LIGHTPOST IS PREWIRED 24 VOLTS AND
INTEGRATES A UNIVERSAL TWIST - LOCK TENON FOR
QUICK AND SAFE WIRELESS CONNECTION.

ALUMINUM TAPERED POLE

NEW ARCHITECTURAL TAPERED POLE ASSEMBLY,
CHEMICALLY BOUNDED TOGETHER. TESTED TO
WITHSTAND GREATER LOADS AND WINDS ALMOST
TWICE THAT OF REGULAR ALUMINUM POLE.
(REFER TO OUR WEBSITE FOR TESTS)

DIGITAL PRINTING

DIGITALLY INKJET PRINTED SURFACES WITH
HIGH-DEFINITION IMAGES OF VARIOUS TEXTURES.

"DUROCLEAR" COATING

APPLICATION OF A PROTECTIVE UV CLEAR COAT
"DUROCLEAR" TO INCREASE LONG-TERM
DURABILITY, PROTECT AGAINST FADING AND
EXTEND LIFE WEATHERING.

DRIVER

2 DRIVERS 96W CLASSE 2 IP67 (120-277V-50/60HZ).
MOUNTED ON A PLATE AT THE BASE OF THE
POLE BEHIND THE ACCESS DOOR, EASILY
DISCONNECTABLE. EACH DRIVER COMES WITH
A POTENTIOMETER THAT ALLOWS INDIVIDUAL
DIMMING OF ACCENTS AND FUNCTIONAL LIGHTING.
THE DRIVER INCLUDES 5 OPTIONS DIMMING (RX,
TRIAC, 0-10 V, 1-10 V, 10 V PWM).

OPERATING TEMPERATURE: -40 °C TO 70 °C.

BASE PLATE AND COVER

DUAL BOLT CIRCLES (IMAGE).
DIGITALLY PRINTED BASE COVER.

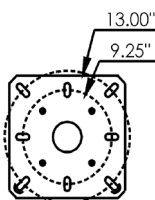

12.5"

6.5"

3.5"



24
VOLTS

IMAGE
OF SELECTED
TEXTURE

luxTM
AESTHETICALLY LUMINOUS

OPTIONS

- TEXTURE/COLOR
- LED ACCENT ON POLE AND LUMINAIRE
- HEIGHT

*Refer to Specification Sheet

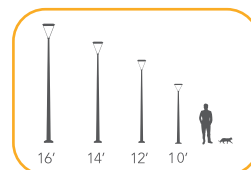

version 02 | 2024-06-03

We reserve the right to change specifications and equipment without notice.



CREATIVE URBAN LIGHTING FURNITURE

LIGHTPOST

MODEL T (Patent pending)

NEW ALUMINUM TAPERED POLE ASSEMBLY
CHEMICALLY BOUNDED TOGETHER

DIGITALLY INKJET PRINTED SURFACES WITH
HIGH-DEFINITION IMAGES OF VARIOUS TEXTURES

TOTALLY PREWIRED LOW VOLTAGE (24 VDC)

INTEGRATED LED ACCENTS

UV CLEAR COAT " DUROCLEAR " TO PROTECT
AGAINST FADING



z lux™
AESTHETICALLY LUMINOUS

BRINGING TO LIFE A NEW
AESTHETIC DIMENSION WITH
UNIQUE LIGHT SIGNATURE

www.zilux.com

TECHNICAL SHEET

LIGHTPOST MODEL T (Patent pending)

LUMINAIRE

LUMINAIRE HEAD INTEGRATING 2 UNIVERSAL SEALED LED MODULES ADJUSTED TO 18 WATTS EACH (0-20 WATTS MAX). OFFERED IN TYPE II, III OR V LIGHT DISTRIBUTION.

(UP TO 140 LUMENS PER WATT)

*6 LED MODULES AVAILABLE IN OPTION.

LED ACCENT

STANDARD WHITE STRIPS LED INTEGRATED ON TWO SIDES OF THE LUMINAIRE AND CORNERS OF THE POLE ARE HIDDEN BY AN ACRYLIC STRIPE PRINTED WITH THE SAME TEXTURE AS POLE(0-100 LUMENS/WATT). CHOICE OF LED COLORS AVAILABLE IN OPTION:

(RGBW for luminaire head only)

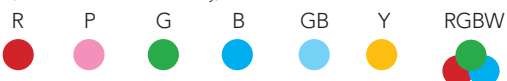

24 VOLTS SYSTEM

THE LIGHTPOST IS PREWIRED 24 VOLTS AND INTEGRATES A UNIVERSAL TWIST - LOCK TENON FOR QUICK AND SAFE WIRELESS CONNECTION.

24
VOLTS

ALUMINUM TAPERED POLE

NEW ARCHITECTURAL TAPERED POLE ASSEMBLY, CHEMICALLY BOUNDED TOGETHER. TESTED TO WITHSTAND GREATER LOADS AND WINDS ALMOST TWICE THAT OF REGULAR ALUMINUM POLE. (REFER TO OUR WEBSITE FOR TESTS)

DIGITAL PRINTING

DIGITALLY INKJET PRINTED SURFACES WITH HIGH-DEFINITION IMAGES OF VARIOUS TEXTURES.

IMAGE
OF SELECTED
TEXTURE

" DUROCLEAR " COATING

APPLICATION OF A PROTECTIVE UV CLEAR COAT " DUROCLEAR " TO INCREASE LONG - TERM DURABILITY, PROTECT AGAINST FADING AND EXTEND LIFE WEATHERING.

DRIVER

2 DRIVERS 96W CLASSE 2 IP67 (120-277V-50/60HZ). MOUNTED ON A PLATE AT THE BASE OF THE POLE BEHIND THE ACCESS DOOR, EASILY DISCONNECTABLE. EACH DRIVER COMES WITH A POTENTIOMETER THAT ALLOWS INDIVIDUAL DIMMING OF ACCENTS AND FUNCTIONAL LIGHTING. THE DRIVER INCLUDES 5 OPTIONS DIMMING (RX, TRIAC, 0-10 V, 1-10 V, 10 V PWM).

OPERATING TEMPERATURE: -40 °C TO 70 °C.

BASE PLATE AND COVER

DUAL BOLT CIRCLES (IMAGE).
DIGITALLY PRINTED BASE COVER.

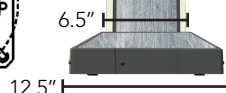
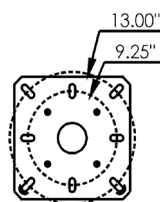

lux
AESTHETICALLY LUMINOUS

OPTIONS

- TEXTURE/COLOR
- LED ACCENT ON POLE AND LUMINAIRE
- HEIGHT

*Refer to Specification Sheet

version 02 | 2024-06-03

We reserve the right to change specifications and equipment without notice.

CREATIVE URBAN LIGHTING FURNITURE

THE MINIS
(Patent pending)

MODEL MP



MODEL MT

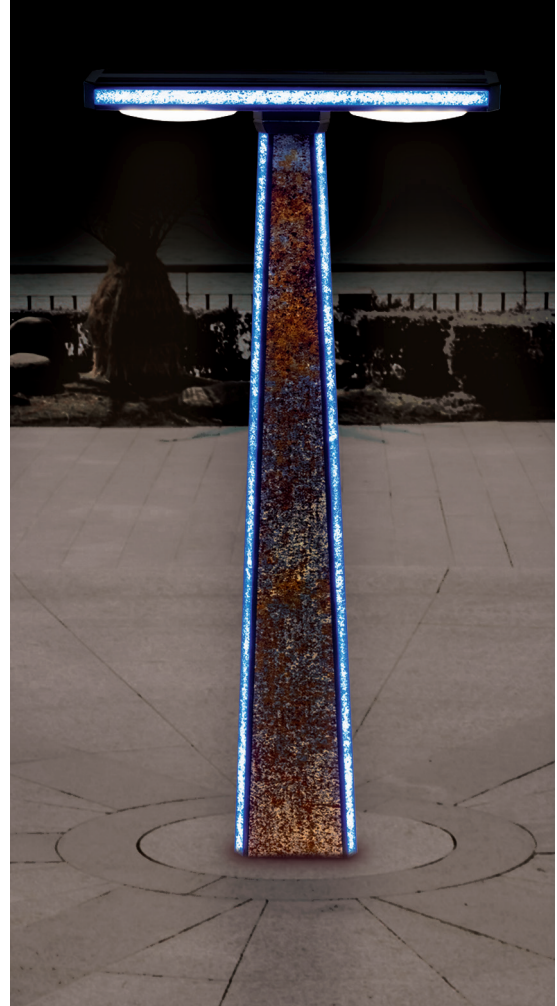

NEW ALUMINUM TAPERED POLE ASSEMBLY
CHEMICALLY BOUNDED TOGETHER

DIGITALLY INKJET PRINTED SURFACES WITH
HIGH-DEFINITION IMAGES OF VARIOUS TEXTURES

TOTALLY PREWIRED LOW VOLTAGE (24 VDC)

INTEGRATED LED ACCENTS

UV CLEAR COAT "DUROCLEAR" TO PROTECT
AGAINST FADING



BRINGING TO LIFE A NEW
AESTHETIC DIMENSION WITH
UNIQUE LIGHT SIGNATURE

www.zilux.com

TECHNICAL SHEET

THE MINIS (Patent pending)

LUMINAIRE

LUMINAIRE HEAD INTEGRATING 1 UNIVERSAL SEALED LED MODULE ADJUSTED TO 18 WATTS EACH (0-20 WATTS MAX). OFFERED IN TYPE III ASYMMETRICAL LIGHT DISTRIBUTION. (>2000 LUMENS PER MODULE).

LED ACCENT

STANDARD WHITE STRIPS LED INTEGRATED ON TWO SIDES OF THE LUMINAIRE AND CORNERS OF THE POLE ARE HIDDEN BY AN ACRYLIC STRIPE PRINTED WITH THE SAME TEXTURE AS POLE.(0-100 LUMENS/WATT). CHOICE OF LED COLORS AVAILABLE IN OPTION :

(RGBW for luminaire head only)

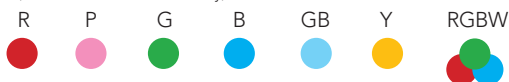

24 VOLTS SYSTEM

MINI LIGHTPOST PREWIRED 24 VOLTS AND INTEGRATES A UNIVERSAL TWIST - LOCK TENON FOR QUICK AND SAFE WIRELESS CONNECTION.

24
VOLTS

ALUMINUM TAPERED POLE

NEW ARCHITECTURAL TAPERED POLE ASSEMBLY, CHEMICALLY BOUNDED TOGETHER. TESTED TO WITHSTAND GREATER LOADS AND WINDS ALMOST TWICE THAT OF REGULAR ALUMINUM POLE. (REFER TO OUR WEBSITE FOR TESTS)

IMAGE
OF SELECTED
TEXTURE

DIGITAL PRINTING

DIGITALLY INKJET PRINTED SURFACES WITH HIGH - DEFINITION IMAGES OF VARIOUS TEXTURES.

" DUROCLEAR " COATING

APPLICATION OF A PROTECTIVE UV CLEAR COAT " DUROCLEAR " TO INCREASE LONG - TERM DURABILITY, PROTECT AGAINST FADING AND EXTEND LIFE WEATHERING.

DRIVER

1 DRIVER 96W CLASS 2 IP67 (120-277V-50/60HZ) MOUNTED ON A PLATE AT THE BASE OF THE POLE, EASILY DISCONNECTABLE. THE DRIVER INCLUDES 5 OPTIONS DIMMING (RX, TRIAC, 0-10 V, 1-10 V, 10 V PWM).

OPERATING TEMPERATURE: -40 °C À 70 °C.

BASE PLATE

BOLT CIRCLE (IMAGE).

MODEL MP 1 LED MODULE



OPTIONS

- TEXTURE/COLOR
- LED ACCENT ON POLE AND LUMINAIRE
- HEIGHT

*Refer to Specification Sheet

MINISTM
AESTHETICALLY LUMINOUS

MODEL MT 2 LED MODULES

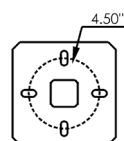

CREATIVE URBAN LIGHTING FURNITURE

THE MINIS
(Patent pending)

MODEL MV



MODEL MF



NEW ALUMINUM TAPERED POLE ASSEMBLY
CHEMICALLY BOUNDED TOGETHER

DIGITALLY INKJET PRINTED SURFACES WITH
HIGH-DEFINITION IMAGES OF VARIOUS TEXTURES

TOTALLY PREWIRED LOW VOLTAGE (24 VDC)

INTEGRATED LED ACCENTS

UV CLEAR COAT "DUROCLEAR" TO PROTECT
AGAINST FADING

z luxTM
AESTHETICALLY LUMINOUS

BRINGING TO LIFE A NEW
AESTHETIC DIMENSION WITH
UNIQUE LIGHT SIGNATURE

www.zilux.com

TECHNICAL SHEET

THE MINIS (Patent pending)

LUMINAIRE

LUMINAIRE HEAD INTEGRATING 1 UNIVERSAL SEALED LED MODULE ADJUSTED TO 18 WATTS EACH (0-20 WATTS MAX). OFFERED IN TYPE III ASYMMETRICAL LIGHT DISTRIBUTION.
(>2000 LUMENS PER MODULE).

LED ACCENT

STANDARD WHITE STRIPS LED INTEGRATED ON TWO SIDES OF THE LUMINAIRE AND CORNERS OF THE POLE ARE HIDDEN BY AN ACRYLIC STRIPE PRINTED WITH THE SAME TEXTURE AS POLE.(0-100 LUMENS/WATT). CHOICE OF LED COLORS AVAILABLE IN OPTION



24 VOLTS SYSTEM

MINI LIGHTPOST PREWIRED 24 VOLTS AND INTEGRATES A UNIVERSAL TWIST - LOCK TENON FOR QUICK AND SAFE WIRELESS CONNECTION.



ALUMINUM TAPERED POLE

NEW ARCHITECTURAL TAPERED POLE ASSEMBLY, CHEMICALLY BOUNDED TOGETHER. TESTED TO WITHSTAND GREATER LOADS AND WINDS ALMOST TWICE THAT OF REGULAR ALUMINUM POLE. (REFER TO OUR WEBSITE FOR TESTS)



DIGITAL PRINTING

DIGITALLY INKJET PRINTED SURFACES WITH HIGH-DEFINITION IMAGES OF VARIOUS TEXTURES.

" DUROCLEAR " COATING

APPLICATION OF A PROTECTIVE UV CLEAR COAT " DUROCLEAR " TO INCREASE LONG-TERM DURABILITY, PROTECT AGAINST FADING AND EXTEND LIFE WEATHERING.

DRIVER

1 DRIVER 96W CLASS 2 IP67 (120-277V-50/60HZ) MOUNTED ON A PLATE AT THE BASE OF THE POLE, EASILY DISCONNECTABLE. THE DRIVER INCLUDES 5 OPTIONS DIMMING (RX, TRIAC, 0-10V, 1-10V, 10V PWM).

OPERATING TEMPERATURE: -40 °C À 70 °C.

BASE PLATE

BOLT CIRCLE (IMAGE).

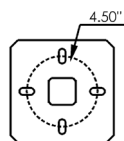

MODEL MV 1 LED MODULE



OPTIONS

- TEXTURE/COLOR
- LED ACCENT ON POLE AND LUMINAIRE
- HEIGHT

*Refer to Specification Sheet

MINIS
AESTHETICALLY LUMINOUS

MODEL MF 1 LED MODULE

