

CREATIVE URBAN LIGHTING FURNITURE

COLUMN

LIGHT COLUMN

(Patent pending)

NEW ALUMINUM AND ACRYLIC COLUMN
ASSEMBLY CHEMICALLY BOUNDED TOGETHER

DIGITALLY INKJET PRINTED SURFACES WITH
HIGH-DEFINITION IMAGES OF VARIOUS TEXTURES

TOTALLY PREWIRED LOW VOLTAGE (24 VDC)

INTEGRATED LED ACCENTS

UV CLEAR COAT " DUROCLEAR " TO PROTECT
AGAINST FADING



zilux[™]
AESTHETICALLY LUMINOUS

BRINGING TO LIFE A NEW
AESTHETIC DIMENSION WITH
UNIQUE LIGHT SIGNATURE

www.zilux.com

TECHNICAL SHEET

LIGHT COLUMN (Patent pending)

DIMENSION

6.5" x 6.5"

AVAILABLE HEIGHT

24" TO 10'

ALUMINUM AND ACRYLIC COLUMN

NEW ALUMINUM AND ACRYLIC COLUMN ASSEMBLY CHEMICALLY BOUNDED TOGETHER. TESTED TO WITHSTAND GREATER LOADS AND WINDS ALMOST TWICE THAT OF REGULAR ALUMINUM COLUMN. (UP TO 100 LUMEN/WATT)
(REFER TO OUR WEBSITE FOR TESTS)

COLUMN LIGHTING

WHITE LED STRIPS ARE VERTICALLY INTEGRATED INSIDE THE COLUMN WITH 36 WATTS/METER.

LED ACCENT

STANDARD WHITE STRIPS LED INTEGRATED ON 4 CORNERS OF THE COLUMN ARE HIDDEN BY AN ACRYLIC STRIPE PRINTED WITH THE SAME TEXTURE AS COLUMN. CHOICE OF LED COLORS AVAILABLE IN OPTION:



24 VOLTS SYSTEM

THE COLUMN IS PREWIRED 24 VOLTS.

DIGITAL PRINTING

DIGITALLY INKJET PRINTED SURFACES WITH HIGH-DEFINITION IMAGES OF VARIOUS TEXTURES

"DUROCLEAR" COATING

APPLICATION OF A PROTECTIVE UV CLEAR COAT "DUROCLEAR" TO INCREASE LONG-TERM DURABILITY, PROTECT AGAINST FADING AND EXTEND LIFE WEATHERING.

DRIVER

1 DRIVER 96W CLASS 2 IP67 (120-277V-50/60HZ) MOUNTED ON A PLATE AT THE BASE OF THE COLUMN, EASILY DISCONNECTABLE. THE DRIVER INCLUDES 5 OPTIONS DIMMING (RX, TRIAC, 0-10 V, 1-10 V, 10 V PWM).
(2 drivers for column 8' and more)

OPERATING TEMPERATURE: -40 °C TO 70 °C.

BASE PLATE AND COVER

DUAL BOLT CIRCLES (IMAGE).
DIGITALLY PRINTED BASE COVER.
(For column 8' and more)

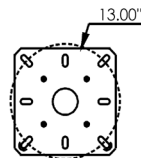

10'-8'

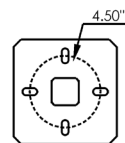

48"-42"-36"-24"



OPTIONS

- TEXTURE/COLOR
- LED ACCENT ON COLUMN
- HEIGHT

*Refer to Specification Sheet

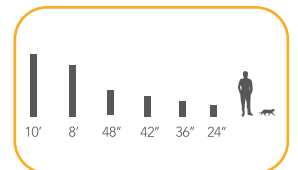



CREATIVE URBAN LIGHTING FURNITURE

COLUMN

ARTISTIC COLUMN

(Patent pending)

NEW ALUMINUM COLUMN ASSEMBLY CHEMICALLY
BOUNDED TOGETHER

DIGITALLY INKJET PRINTED SURFACES WITH
HIGH-DEFINITION IMAGES OF VARIOUS TEXTURES

TOTALLY PREWIRED LOW VOLTAGE (24 VDC)

INTEGRATED LED ACCENTS

UV CLEAR COAT "DUROCLEAR" TO PROTECT AGAINST
FADING

LET LIGHT PASS THROUGH ITS CREATIVE SHAPES
RESULTING FROM AN ARTISTIC DESIGN, THANKS TO CNC
CUTTING



zilux[™]
AESTHETICALLY LUMINOUS

BRINGING TO LIFE A NEW
AESTHETIC DIMENSION WITH
UNIQUE LIGHT SIGNATURE

www.zilux.com

TECHNICAL SHEET

ARTISTIC COLUMN (Patent pending)

DIMENSION

8" x 8"

AVAILABLE HEIGHT

36" TO 12'

ALUMINUM COLUMN

NEW ALUMINUM COLUMN ASSEMBLY CHEMICALLY BOUNDED TOGETHER. EACH FACE VERTICALLY INCORPORATES VARIOUS ARTISTIC PERFORATED DESIGNS. TESTED TO WITHSTAND GREATER LOADS AND WINDS ALMOST TWICE THAT OF REGULAR ALUMINUM COLUMN.

(REFER TO OUR WEBSITE FOR TESTS)

ARTISTIC DESIGN

ARTISTIC DESIGN BY CNC CUTTING. CUSTOM DESIGN UPON REQUEST.

COLUMN LIGHTING

2 INTEGRATED UNIVERSAL SEALED LED MODULES ADJUSTED TO 18 WATTS/2000 LUMENS EACH (0 - 20 WATTS MAX) WITH 60 DEGREE PROJECTION TO CREATE LIGHT EFFECTS THROUGH THE ARTISTIC DESIGNS OF THE COLUMN.

LED ACCENT

STANDARD WHITE STRIPS LED INTEGRATED ON 4 CORNERS OF THE COLUMN ARE HIDDEN BY AN ACRYLIC STRIPE PRINTED WITH THE SAME TEXTURE AS COLUMN. CHOICE OF LED COLORS AVAILABLE IN OPTION:



24 VOLTS SYSTEM

THE COLUMN IS PREWIRED 24 VOLTS.

DIGITAL PRINTING

DIGITALLY INKJET PRINTED SURFACES WITH HIGH-DEFINITION IMAGES OF VARIOUS TEXTURES.

"DUROCLEAR" COATING

APPLICATION OF A PROTECTIVE UV CLEAR COAT "DUROCLEAR" TO INCREASE LONG-TERM DURABILITY, PROTECT AGAINST FADING AND EXTEND LIFE WEATHERING.

DRIVER

1 DRIVER 96W CLASS 2 IP67 (120-277V-50/60HZ) MOUNTED ON A PLATE AT THE BASE OF THE COLUMN, EASILY DISCONNECTABLE. THE DRIVER INCLUDES 5 OPTIONS DIMMING (RX, TRIAC, 0-10 V, 1-10 V, 10 V PWM).

OPERATING TEMPERATURE: -40 °C TO 70 °C.

BASE PLATE AND COVER

DUAL BOLT CIRCLES (IMAGE)
DIGITALLY PRINTED BASE COVER.
(For column 8' and more)



OPTIONS

- TEXTURE/COLOR
- LED ACCENT ON COLUMN
- HEIGHT

*Refer to Specification Sheet

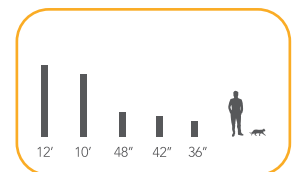
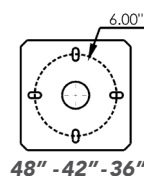
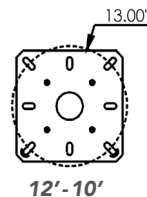

version 02 | 2024-06-03

We reserve the right to change specifications and equipment without notice.